

kadaster



Collaboration between the private sector and the national mapping agencies

Martin Salzmann
Cadastre, Land Registry and Mapping Agency
The Netherlands

V CLGE Conference of the European Surveyor and GI
Lausanne, Switzerland, April 20, 2017

kadaster

Public meets private sector: *kings, rebels, surveyors and cartographers*



Reconstruction through the ages

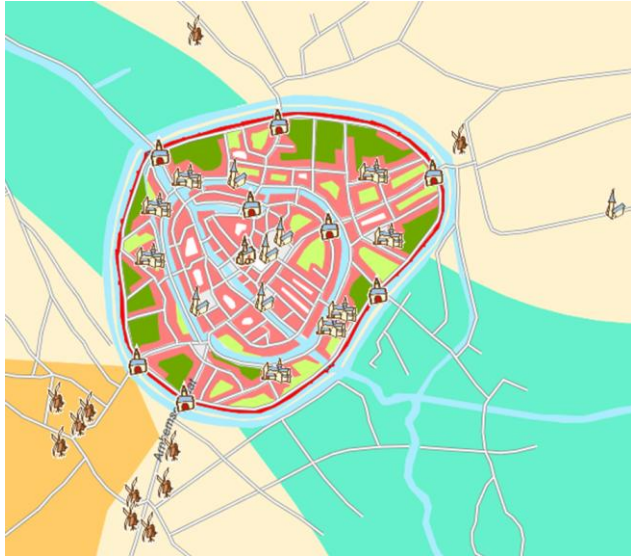

Jacob van Deventer in 1717

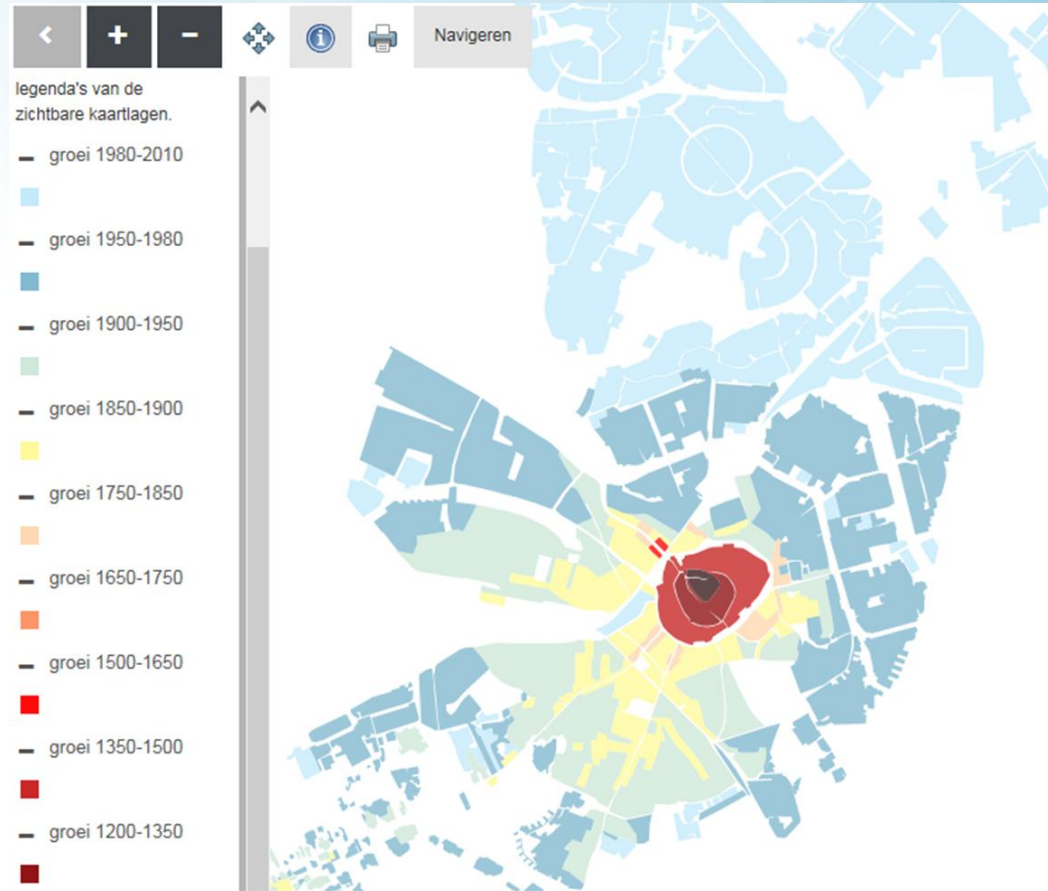

<https://landschapinnederland.nl/verstedelijingskaart>

Public and Crowdsourced data



PDOK Publieke
Dienstverlening
op de Kaart

<https://www.pdok.nl>

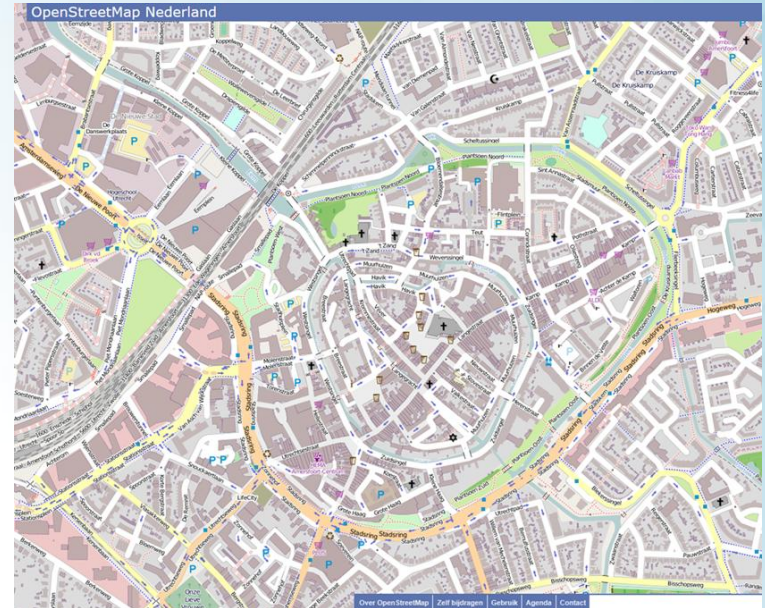

<http://www.openstreetmap.nl>



OpenStreetMap

The global default map

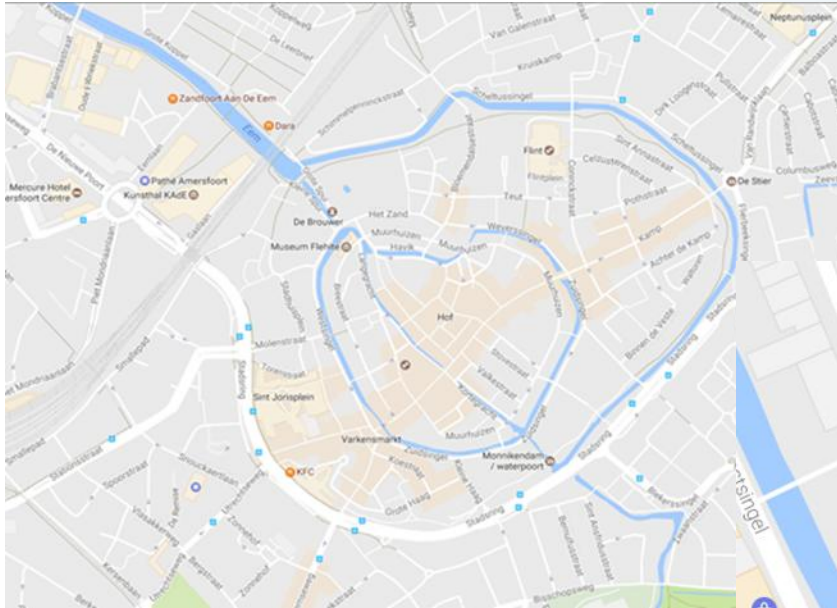

Autonomous driving

HDmaps; Road DNA

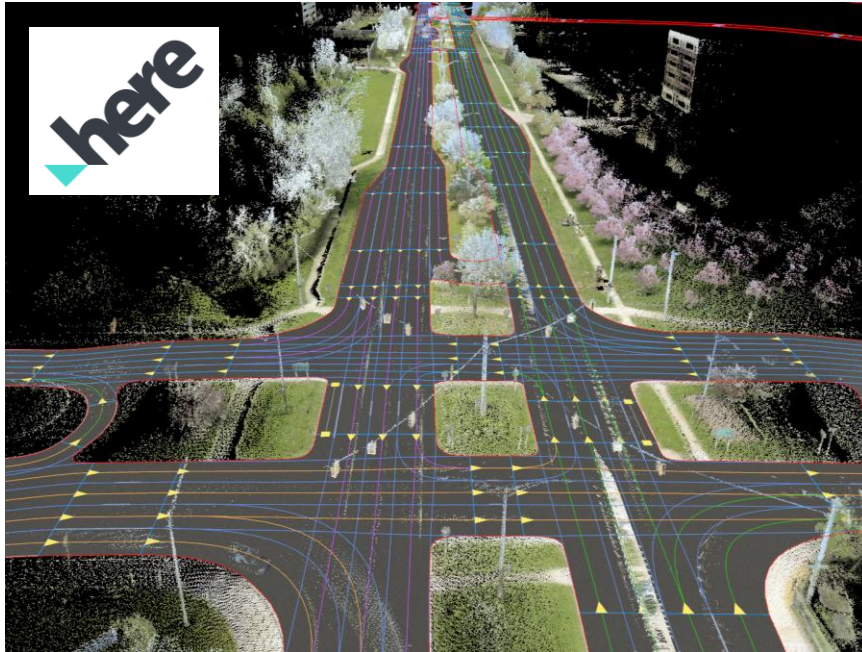

Intermediate observations

- **Sharing**
open data (NMCA's) – shared platform (OSM)
- closed data (commercial)
- **Local Use, Global Tools**
- **Standardisation**
W3C, OGC, NT-ITS,

Evolution in Surveying



Improving maps with users (VGI)

Users can report errors in our maps providing feedback on the map itself.
Earlier feedback and status of actions undertaken are visible on-line

<https://www.verbeterdekaart.nl/>

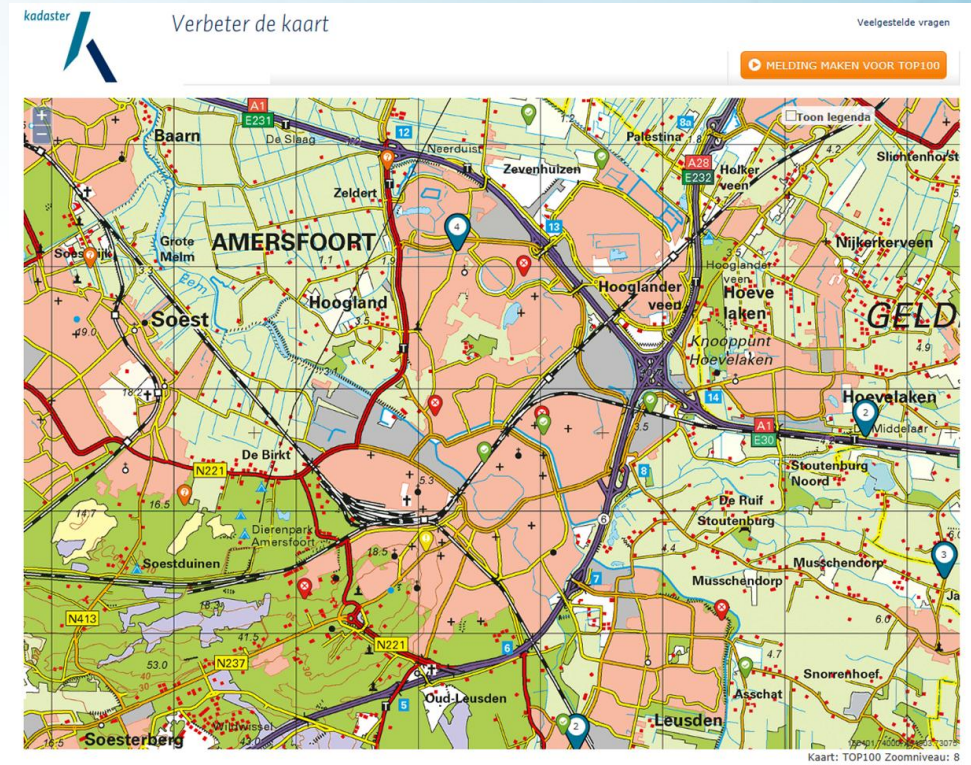

Example of a feedback report

Melding BRT00003134

Gemeld op: TOP10

Geregistreerd op: 23-11-2016 21:10

Status: Goedgekeurd, ingepland door bronhouder

Omschrijving: school gesloopt na brand

Bronhouder: Kadaster

Gewijzigd op: 23-01-2017 08:27

Toelichting bronhouder: Bebouwing zal worden aangepast met fotobeeld 2016, in release R2_februari_2017

kadaster *Verbeter de kaart* Veelgestelde vragen

MELDING MAKEN VOOR TOP100

Melding BRT00003134

Gemeld op: TOP10

Geregistreerd op: 23-11-2016 21:10

Status: Goedgekeurd, ingepland door bronhouder

Omschrijving: school gesloopt na brand

Bronhouder: Kadaster

Gewijzigd op: 23-01-2017 08:27

Toelichting bronhouder: Bebouwing zal worden aangepast met fotobeeld 2016, in release R2_februari_2017

Kaart: TOP100 Zoomniveau: 8

Results of reporting errors by users

Basemap

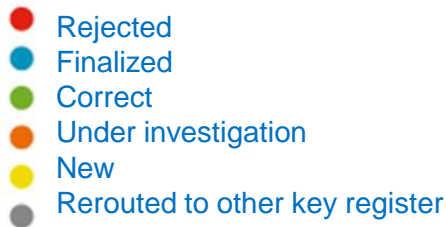
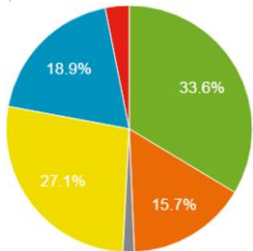
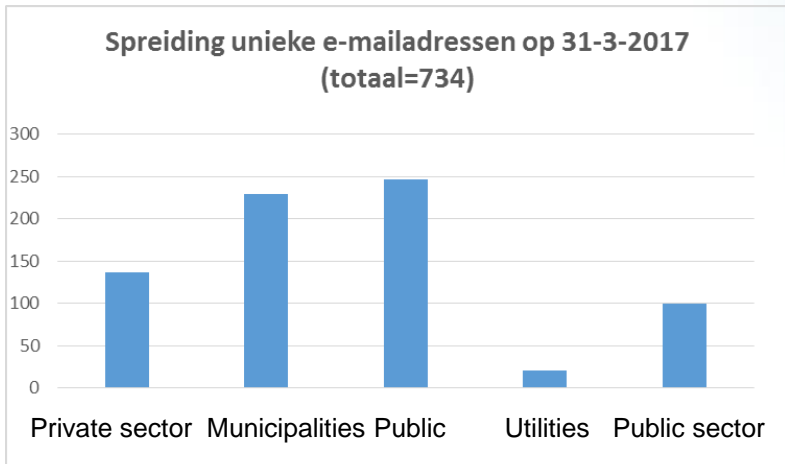

Topographic map

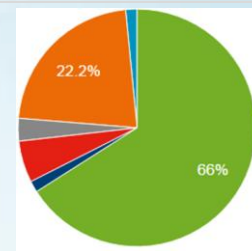
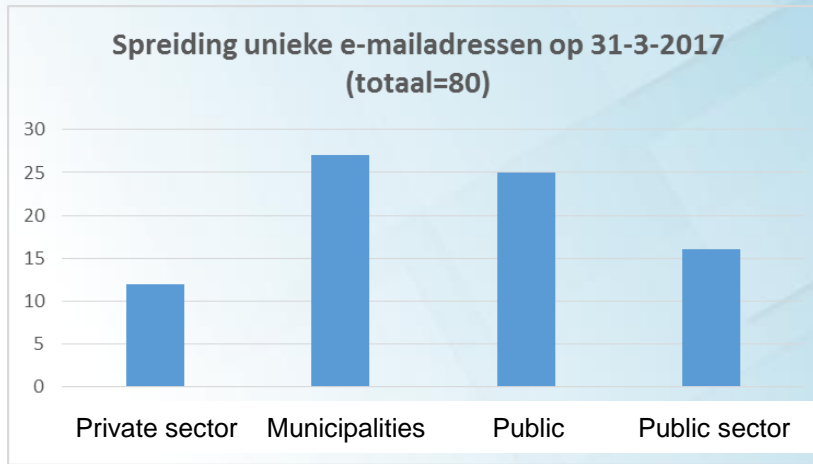



6

Edwin van Vilste

21



Map of the future? Decisions made in a virtual world



Intermediate observations

- **Collaborative improvements**
trust creates better products/services for all
- **Eliminate obstacles (e.g. IPR)**
e.g architect → BIM → building (geo) → 3D cadastre
- **Research and Development**
partner science-private sector-NMCA's

Public sector meets Private Sector meets Developers meets Users

Geo4Web

Availability ✓
Accessibility ✗
Connectivity ✗

The new order in the information society

Public sector

Private sector

Maps



User

Contributors

Public sector APIs Private sector

Developers

Services



Communities

Future geoprofessionals

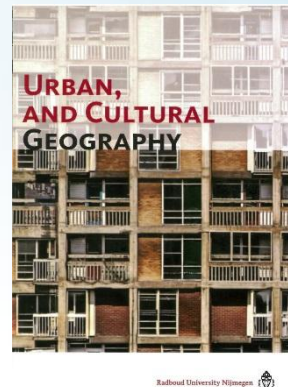
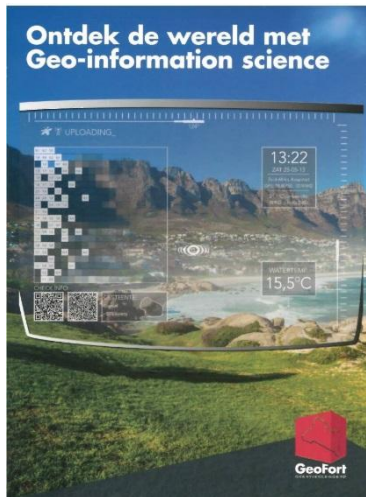

Wilt u samen HAS Hogeschool en Geo Media & Design voor u betrekken?

- Stageleiders
- Alumnusstudenten
- Projecten
- Cursussen
- Samenwerking

Contactpersoon voor samenwerking met Geo Media & Design:

Marten de Bakker
T: +31 (0)6 550 2058
E: M.deBakker@has.nl
Postbus 30308
3200 AA 's-Hertogenbosch
www.has Hogeschool.nl/geomediaanddesign
www.bakermartendebakker.nl

has hogeschool

Cursus GeoLab Data Informatie

Sociale geografie Bedrijfsopdracht Fysische geografie

Trends **GEO MEDIA & DESIGN** Apps

Toepassen Voedsel

User interface Groene ruimte Infographics

Landbouw Stage Open source

- Partners:
- public sector agencies
 - geobusiness NL
 - education sector

Concluding Remarks

dominant trends

- **Rethink sharing information and share!**
- **Partner in R&D and standardisation**
- **Shared interest in educating professionals**
- **Adapt together to changing roles in a changing information society**